



---

**Price List**

Please note the following statements are excerpts from the FAA Advisory Circular 20-62C entitled "ELIGIBILITY, QUALITY, AND IDENTIFICATION OF APPROVED REPLACEMENT PARTS":

## Background:

An increasing amount of replacement parts (including standard parts), materials, appliances and instruments are offered for sales as being of aircraft quality and origin of these units are unknown. Users of such units are usually not aware of the potential hazards involved with replacement parts that are not eligible for use on certified aircraft. Frequently such units are deceptively advertised and presented as "unused," "like new," or "remanufactured." This implies that the quality of such units is equal to an original or appropriately repaired or overhauled.

The performance rules for replacement of parts and materials used in the maintenance and alteration of U.S. certificated aircraft are specified in Federal Aviation Regulations (FAR) 43.13 and FAR 145.57. The responsibility for the continued airworthiness of the aircraft, which includes the replacement of parts, is the responsibility of the owner/operator as outlined in FAR 91.163, FAR 121.363, FAR 123.45, FAR 127.131 and FAR 135.143 (a).

## Identification of the Approved Parts:

Approved serviceable replacement parts are identified as follows:

1. By an FAA Form 8130-3 (Formerly FAA Form 186), Airworthiness Approval Tag. An Airworthiness Approval Tag identifies a part or group of parts that have been approved by an authorized FAA representative.
2. By an FAA Technical Standard Order (TSO) number and identification mark that indicates the part or appliance has been manufactured under the requirements of FAR 37.
3. By an FAA/PMA symbol, together with the manufacturer's name, trademark or symbol, part number, and the make and model of the type certificated product on which the part is eligible for installation, stamped on the part. An FAA Parts Manufacturer Approval (FAA/PMA) is issued under FAR 21.305. The make and model information may be on a tag attached to the part.
4. By shipping ticket, invoice, or other document which provides evidence that the part was produced by a manufacturer holding an FAA Approved Production Inspection System issued under FAR 21, Subpart F, or by a manufacturer holding an FAA Production Certificate issued under FAR 21, Subpart G.
5. By a certificate of airworthiness for export issued by a foreign government under the provisions of FAR 21, Subpart N.

## Know Your Supplier:

It has come to our attention that many reproduced parts and components, particularly instruments which have been manufactured by persons other than the original manufacturer, are available for purchase and installation on U.S. certificated aircraft. Often, an original part is used as a sample to produce duplicates. The reproduced parts appear to be as good as the original part; however, there are many unknown factors to be considered that may not be readily apparent to the purchaser, i.e. heat treating, plating, inspections, tests, and calibrations. All too often the faulty part is not discovered until a malfunction or an accident occurs.

## Summary:

In accordance with FAR's, certification of materials, parts, and appliances for return to service, for use on aircraft, is the responsibility of the person or agency who signs the approval. The owner/operator, as denoted in paragraph 3 of this advisory circular, is responsible for the continued airworthiness of the aircraft. To assure continued safety in aircraft operation, it is essential that great care be used when inspecting, testing and determining the acceptability of all parts and materials. Particular caution should be exercised when the identity of materials, parts, and appliances cannot be established or when their origin is in doubt.

All Kelly Aerospace Energy Systems products offered herein meet the requirement of FAA Advisory Circular 20-62C.

## **General Terms and Conditions:**

1. All prices are subject to change without notice. Invoice prices will be seller's price in effect at time of shipment.
2. All prices are F.O.B. Kelly Aerospace Energy Systems plant point of shipment.
3. All prices in this catalog are less sales and excise taxes. All quotations and/or contracts shall be subject to increase without notice by the amount of any sales, use or excise taxes levied against such transactions by any Federal, State, Municipal or other domestic or foreign government agency unless tax exemption certificate can be furnished which will meet the approval of such agency.
4. All orders are payable in U.S. funds.
5. Kelly Aerospace Energy Systems is not responsible for any part left on the unit which is not part of the normal overhaul.
6. Kelly Aerospace Energy Systems reserves the right to return any unit that cannot be overhauled disassembled.

**Prices are subject to change without notice.**

## Table of Contents

New PMA Ignition Harnesses .....	Page 4
Overhauled Dual Magneto Ignition Harnesses .....	Page 8
Overhauled CMI/Bendix Magnetos .....	Page 8
Overhauled Slick Magnetos .....	Page 13
New CMI/Bendix Magneto PMA Parts .....	Page 15
New Slick Magneto PMA Parts .....	Page 20
New CMI/Bendix Magneto Repair Kits .....	Page 21
New Ignition Harness Replacement Parts .....	Page 22
Harness Parts Drawing .....	Page 23
Warranty Policy .....	Page 24
Core Chargeback Policy .....	Page 25
Returned Goods Policy .....	Page 26

# Factory New Ignition Harness

Prices effective January 2017

Part Number	Description	List Price	Direct Price
KA11480	Harness 6 CYL S100; replaces Slick M1480	\$731.40	\$490.04
KA11480E	Harness 6 CYL S100 w/Elbows	\$931.40	\$624.04
KA11730	Harness 6 CYL S100; replaces Slick M1730	\$711.70	\$476.84
KA11730E	Harness 6 CYL S100 w/Elbows	\$911.70	\$610.84
KA11740	Harness 6 CYL S100; replaces Slick M1740	\$711.70	\$476.84
KA11740E	Harness 6 CYL S100 w/Elbows	\$911.70	\$610.84
KA11780	Harness 4 CYL S200; replaces Slick M1780	\$495.30	\$331.85
KA11780E	Harness 4 CYL S200 w/Elbows	\$645.30	\$432.35
KA11878	Harness 6 CYL S200; replaces Slick M1878	\$737.10	\$493.86
KA11878E	Harness 6 CYL S200 w/Elbows	\$937.10	\$627.86
KA11884	Harness 6 CYL S200; replaces Slick M1884	\$737.10	\$493.86
KA11884E	Harness 6 CYL S200 w/Elbows	\$937.10	\$627.86
KA11950	Harness 6 CYL S100; replaces Slick M1950	\$711.70	\$476.84
KA11950E	Harness 6 CYL S100 w/Elbows	\$911.70	\$610.84
KA11978	Harness 6 CYL S200; replaces Slick M1978	\$672.20	\$450.37
KA11978E	Harness 6 CYL S200 w/Elbows	\$872.20	\$584.37
KA12007	Harness 4 CYL S200; replaces Slick M2007	\$510.40	\$341.97
KA12007E	Harness 4 CYL S200 w/Elbows	\$660.40	\$442.47
KA12015	Harness 6 CYL S100; replaces Slick M2015	\$711.70	\$476.84
KA12015E	Harness 6 CYL S100 w/Elbows	\$911.70	\$610.84
KA12037	Harness 6 CYL S100; replaces Slick M2037	\$653.60	\$437.91
KA12037E	Harness 6 CYL S100 w/Elbows	\$853.60	\$571.91
KA12045	Harness 4 CYL S200; replaces Slick M2045	\$514.20	\$344.51
KA12045E	Harness 4 CYL S200 w/Elbows	\$664.20	\$445.01
KA12112	Harness 4 CYL S200; replaces Slick M2112	\$514.20	\$344.51
KA12112E	Harness 4 CYL S200 w/Elbows	\$664.20	\$445.01
KA12120	Harness 6 CYL S100; replaces Slick M2120	\$737.10	\$493.86
KA12120E	Harness 6 CYL S100 w/Elbows	\$937.10	\$627.86
KA12121	Harness 6 CYL S200; replaces Slick M2121	\$711.70	\$476.84
KA12121E	Harness 6 CYL S200 w/Elbows	\$911.70	\$610.84
KA12130	Harness 6 CYL S200; replaces Slick M2130	\$676.70	\$453.39
KA12130E	Harness 6 CYL S200 w/Elbows	\$876.70	\$587.39
KA12154	Harness 6 CYL S200; replaces Slick M2154	\$653.60	\$437.91
KA12154E	Harness 6 CYL S200 w/Elbows	\$853.60	\$571.91
KA12157	Harness 6 CYL S100; replaces Slick M2157	\$653.60	\$437.91
KA12157E	Harness 6 CYL S100 w/Elbows	\$853.60	\$571.91
KA12176	Harness 6 CYL S200; replaces Slick M2176	\$737.10	\$493.86
KA12176E	Harness 6 CYL S200 w/Elbows	\$937.10	\$627.86
KA12216	Harness 6 CYL S100; replaces Slick M2216	\$737.10	\$493.86
KA12216E	Harness 6 CYL S100 w/Elbows	\$937.10	\$627.86

# Factory New Ignition Harness (cont'd)

Prices effective January 2017

Part Number	Description	List Price	Direct Price
KA12235	Harness 4 CYL S100; replaces Slick M2235	\$470.90	\$315.50
KA12235E	Harness 4 CYL S100 w/Elbows	\$620.90	\$416.00
KA12244	Harness 6 CYL S200; replaces Slick M2244	\$737.10	\$493.86
KA12244E	Harness 6 CYL S200 w/Elbows	\$937.10	\$627.86
KA12247	Harness 6 CYL S100; replaces Slick M2247	\$737.10	\$493.86
KA12247E	Harness 6 CYL S100 w/Elbows	\$937.10	\$627.86
KA12259	Harness 6 CYL S200; replaces Slick M2259	\$737.10	\$493.86
KA12259E	Harness 6 CYL S200 w/Elbows	\$937.10	\$627.86
KA12318	Harness 6 CYL S100; replaces Slick M2318	\$737.10	\$493.86
KA12318E	Harness 6 CYL S100 w/Elbows	\$937.10	\$627.86
KA12339	Harness 6 CYL S100; replaces Slick M2339	\$737.10	\$493.86
KA12339E	Harness 6 CYL S100 w/Elbows	\$937.10	\$627.86
KA12351	Harness 4 CYL S200; replaces Slick M2351	\$514.20	\$344.51
KA12351E	Harness 4 CYL S200 w/Elbows	\$664.20	\$445.01
KA12360	Harness 4 CYL S100; replaces Slick M2360	\$514.20	\$344.51
KA12360E	Harness 4 CYL S100 w/Elbows	\$664.20	\$445.01
KA12364	Harness 4 CYL S200; replaces Slick M2364	\$495.50	\$331.99
KA12364E	Harness 4 CYL S200 w/Elbows	\$645.50	\$432.49
KA12365	Harness 4 CYL S200; replaces Slick M2365	\$514.20	\$344.51
KA12365E	Harness 4 CYL S200 w/Elbows	\$664.20	\$445.01
KA12381	Harness 6 CYL S100; replaces Slick M2381	\$653.60	\$437.91
KA12381E	Harness 6 CYL S100 w/Elbows	\$853.60	\$571.91
KA12402	Harness 4 CYL S200; replaces Slick M2402	\$471.30	\$315.77
KA12402E	Harness 4 CYL S200 w/Elbows	\$621.30	\$416.27
KA12411	Harness 4 CYL S200; replaces Slick M2411	\$514.20	\$344.51
KA12411E	Harness 4 CYL S200 w/Elbows	\$664.20	\$445.01
KA12423	Harness 4 CYL S200; replaces Slick M2423	\$514.20	\$344.51
KA12423E	Harness 4 CYL S200 w/Elbows	\$664.20	\$445.01
KA12447	Harness 6 CYL S100; replaces Slick M2447	\$737.10	\$493.86
KA12447E	Harness 6 CYL S100 w/Elbows	\$937.10	\$627.86
KA12474	Harness 6 CYL S200; replaces Slick M2474	\$737.10	\$493.86
KA12474E	Harness 6 CYL S200 w/Elbows	\$937.10	\$627.86
KA12508	Harness 4 CYL S100; replaces Slick M2508	\$495.50	\$331.99
KA12508E	Harness 4 CYL S100 w/Elbows	\$645.50	\$432.49
KA12616	Harness 4 CYL S100; replaces Slick M2616	\$514.20	\$344.51
KA12616E	Harness 4 CYL S100 w/Elbows	\$664.20	\$445.01
KA12628	Harness 6 CYL S100; replaces Slick M2628	\$737.10	\$493.86
KA12628E	Harness 6 CYL S100 w/Elbows	\$937.10	\$627.86
KA12709	Harness 6 CYL S200; replaces Slick M2709	\$676.70	\$453.39
KA12709E	Harness 6 CYL S200 w/Elbows	\$876.70	\$587.39

# Factory New Ignition Harness (cont'd)

Prices effective January 2017

Part Number	Description	List Price	Direct Price
KA12712	Harness 6 CYL S200; replaces Slick M2712	\$737.10	\$493.86
KA12712E	Harness 6 CYL S200 w/Elbows	\$937.10	\$627.86
KA12742	Harness 6 CYL S200; replaces Slick M2742	\$737.10	\$493.86
KA12742E	Harness 6 CYL S200 w/Elbows	\$937.10	\$627.86
KA12745	Harness 6 CYL S200; replaces Slick M2745	\$737.10	\$493.86
KA12745E	Harness 6 CYL S200 w/Elbows	\$937.10	\$627.86
KA12769	Harness 6 CYL S200; replaces Slick M2769	\$737.10	\$493.86
KA12769E	Harness 6 CYL S200 w/Elbows	\$937.10	\$627.86
KA12772	Harness 6 CYL S200; replaces Slick M2772	\$737.10	\$493.86
KA12772E	Harness 6 CYL S200 w/Elbows	\$937.10	\$627.86
KA12778	Harness 6 CYL S100; replaces Slick M2778	\$711.70	\$476.84
KA12778E	Harness 6 CYL S100 w/Elbows	\$911.70	\$610.84
KA12779	Harness 6 CYL S100; replaces Slick M2779	\$711.70	\$476.84
KA12779E	Harness 6 CYL S100 w/Elbows	\$911.70	\$610.84
KA12780	Harness 6 CYL S100; replaces Slick M2780	\$737.10	\$493.86
KA12780E	Harness 6 CYL S100 w/Elbows	\$937.10	\$627.86
KA12790	Harness 6 CYL S200; replaces Slick M2790	\$737.10	\$493.86
KA12790E	Harness 6 CYL S200 w/Elbows	\$937.10	\$627.86
KA12828	Harness 6 CYL S200; replaces Slick M2828	\$737.10	\$493.86
KA12828E	Harness 6 CYL S200 w/Elbows	\$937.10	\$627.86
KA12851	Harness 6 CYL S100; replaces Slick M2851	\$737.10	\$493.86
KA12851E	Harness 6 CYL S100 w/Elbows	\$937.10	\$627.86
KA12854	Harness 6 CYL S200; replaces Slick M2854	\$737.10	\$493.86
KA12854E	Harness 6 CYL S200 w/Elbows	\$937.10	\$627.86
KA12865	Harness 6 CYL S100; replaces Slick M2865	\$737.10	\$493.86
KA12865E	Harness 6 CYL S100 w/Elbows	\$937.10	\$627.86
KA12890	Harness 6 CYL S100; replaces Slick M2890	\$737.10	\$493.86
KA12890E	Harness 6 CYL S100 w/Elbows	\$937.10	\$627.86
KA12896	Harness 6 CYL S100; replaces Slick M2896	\$737.10	\$493.86
KA12896E	Harness 6 CYL S100 w/Elbows	\$937.10	\$627.86
KA12932	Harness 6 CYL S200	\$711.70	\$476.84
KA12932E	Harness 6 CYL S200 w/Elbows	\$911.70	\$610.84
KA12938	Harness 6 CYL S200; replaces Slick M2938	\$711.70	\$476.84
KA12938E	Harness 6 CYL S200 w/Elbows	\$911.70	\$610.84
KA14000	Harness 4 CYL S200; replaces Slick M4000	\$514.20	\$344.51
KA14000E	Harness 4 CYL S200 w/Elbows	\$664.20	\$445.01
KA14001	Harness 4 CYL S200; replaces Slick M4001	\$495.50	\$331.99
KA14001E	Harness 4 CYL S200 w/Elbows	\$645.50	\$432.49
KA14002	Harness 4 CYL S200; replaces Slick M4002	\$495.50	\$331.99
KA14002E	Harness 4 CYL S200 w/Elbows	\$645.50	\$432.49

# Factory New Ignition Harness (cont'd)

Prices effective January 2017

Part Number	Description	List Price	Direct Price
KA14004	Harness 4 CYL S200; replaces Slick M4004	\$495.50	\$331.99
KA14004E	Harness 4 CYL S200 w/Elbows	\$645.50	\$432.49
KA14005	Harness 4 CYL S200; replaces Slick M4000	\$495.50	\$331.99
KA14005E	Harness 4 CYL S200 w/Elbows	\$645.50	\$432.49
KA14006	Harness 4 CYL S200; replaces Slick M4006	\$514.20	\$344.51
KA14006E	Harness 4 CYL S200 w/Elbows	\$664.20	\$445.01
KA14007	Harness 4 CYL S200; replaces Slick M4007	\$495.50	\$331.99
KA14007E	Harness 4 CYL S200 w/Elbows	\$645.50	\$432.49
KA14027	Harness 4 CYL S200; replaces Slick M4027	\$495.50	\$331.99
KA14027E	Harness 4 CYL S200 w/Elbows	\$645.50	\$432.49
KA14033	Harness 4 CYL S100	\$495.50	\$331.99
KA14033E	Harness 4 CYL S100 w/Elbows	\$645.50	\$432.49
KA14045	Harness 4 CYL S100; replaces Slick M4045	\$514.20	\$344.51
KA14045E	Harness 4 CYL S100 w/Elbows	\$664.20	\$445.01
KA16001	Harness 6 CYL S200; replaces Slick M6001	\$711.70	\$476.84
KA16001E	Harness 6 CYL S200 w/Elbows	\$911.70	\$610.84
KA16002	Harness 6 CYL S200; replaces Slick M6002	\$711.70	\$476.84
KA16002E	Harness 6 CYL S200 w/Elbows	\$911.70	\$610.84
KA16014	Harness 6 CYL S200; replaces Slick M6014	\$711.70	\$476.84
KA16014E	Harness 6 CYL S200 w/Elbows	\$911.70	\$610.84
KA16044	Harness 6 CYL S100; replaces Slick M6044	\$711.70	\$476.84
KA16044E	Harness 6 CYL S100 w/Elbows	\$911.70	\$610.84
KA17001	Harness 6 CYL S100	\$737.10	\$493.86
KA17001E	Harness 6 CYL S100 w/Elbows	\$937.10	\$627.86
KA17002	Harness 6 CYL S200	\$737.10	\$493.86
KA17002E	Harness 6 CYL S200 w/Elbows	\$937.10	\$627.86
KA17005	Harness 4 CYL S200	\$495.50	\$331.99
KA17005E	Harness 4 CYL S200 w/Elbows	\$645.50	\$432.49
KA17006	Harness 4 CYL S100	\$495.50	\$331.99
KA17006E	Harness 4 CYL S100 w/Elbows	\$645.50	\$432.49
KA17007	Harness 4 CYL S100	\$495.50	\$331.99
KA17007E	Harness 4 CYL S100 w/Elbows	\$645.50	\$432.49
KA17008	Harness 4 CYL S200	\$495.50	\$331.99
KA17008E	Harness 4 CYL S200 w/Elbows	\$645.50	\$432.49
KA17011	Harness 4 CYL S100	\$495.50	\$331.99
KA17011E	Harness 4 CYL S100 w/Elbows	\$645.50	\$432.49
KA17012	Harness 8 CYL S100	\$1,179.00	\$789.93
KA17012E	Harness 8 CYL S100 w/Elbows	\$1,479.00	\$990.93



# Overhauled Dual Mag Ignition Harness

Prices effective January 2017

Part Number	Description	List Price	Direct Price	Core Charge
10-821414-4R	Dual Ignition Harness - Overhauled	\$745.00	\$499.15	\$100.00
10-821414-6R	Dual Ignition Harness - Overhauled	\$745.00	\$499.15	\$100.00
10-821414-8R	Dual Ignition Harness - Overhauled	\$745.00	\$499.15	\$100.00
10-821414-10R	Dual Ignition Harness - Overhauled	\$745.00	\$499.15	\$100.00
10-821414-14R	Dual Ignition Harness - Overhauled	\$745.00	\$499.15	\$100.00
10-821414-18R	Dual Ignition Harness - Overhauled	\$745.00	\$499.15	\$100.00
10-821415-12R	Dual Ignition Harness - Overhauled	\$745.00	\$499.15	\$100.00
10-821444-6R	Dual Ignition Harness - Overhauled	\$745.00	\$499.15	\$100.00
10-821614-6R	Dual Ignition Harness - Overhauled	\$959.40	\$642.80	\$100.00
10-821614-36R	Dual Ignition Harness - Overhauled	\$959.40	\$642.80	\$100.00
10-821615-4R	Dual Ignition Harness - Overhauled	\$959.40	\$642.80	\$100.00
10-821615-20R	Dual Ignition Harness - Overhauled	\$959.40	\$642.80	\$100.00
10-821624-6R	Dual Ignition Harness - Overhauled	\$959.40	\$642.80	\$100.00
10-821625-4R	Dual Ignition Harness - Overhauled	\$959.40	\$642.80	\$100.00
10-821625-34R	Dual Ignition Harness - Overhauled	\$959.40	\$642.80	\$100.00
10-821635-4R	Dual Ignition Harness - Overhauled	\$959.40	\$642.80	\$100.00
10-821644-6R	Dual Ignition Harness - Overhauled	\$959.40	\$642.80	\$100.00
10-821825-2R	Dual Ignition Harness - Overhauled	\$1,072.30	\$718.44	\$100.00

# Overhauled CMI/Bendix Magnetos

Part Number	Description	List Price	Direct Price	Core Charge
10-163005-2R	Magneto (CMI/Bendix 200 Series)	\$920.00	\$616.40	\$300.00
10-163005-3R	Magneto (CMI/Bendix 200 Series)	\$920.00	\$616.40	\$300.00
10-163005-11R	Magneto (CMI/Bendix 200 Series)	\$920.00	\$616.40	\$300.00
10-163010-2R	Magneto (CMI/Bendix 200 Series)	\$920.00	\$616.40	\$300.00
10-163010-6R	Magneto (CMI/Bendix 200 Series)	\$920.00	\$616.40	\$300.00
10-163010-7R	Magneto (CMI/Bendix 200 Series)	\$920.00	\$616.40	\$300.00
10-163010-10R	Magneto (CMI/Bendix 200 Series)	\$920.00	\$616.40	\$300.00
10-163010-15R	Magneto (CMI/Bendix 200 Series)	\$920.00	\$616.40	\$300.00
10-163015-3R	Magneto (CMI/Bendix 200 Series)	\$920.00	\$616.40	\$300.00
10-163020-2R	Magneto (CMI/Bendix 200 Series)	\$920.00	\$616.40	\$300.00
10-163020-3R	Magneto (CMI/Bendix 200 Series)	\$920.00	\$616.40	\$300.00
10-163020-4R	Magneto (CMI/Bendix 200 Series)	\$920.00	\$616.40	\$300.00
10-163030-1R	Magneto (CMI/Bendix 200 Series)	\$920.00	\$616.40	\$300.00
10-163045-1R	Magneto (CMI/Bendix 200 Series)	\$920.00	\$616.40	\$300.00
10-163045-2R	Magneto (CMI/Bendix 200 Series)	\$920.00	\$616.40	\$300.00
10-163045-3R	Magneto (CMI/Bendix 200 Series)	\$920.00	\$616.40	\$300.00
10-163045-6R	Magneto (CMI/Bendix 200 Series)	\$920.00	\$616.40	\$300.00
10-163045-8R	Magneto (CMI/Bendix 200 Series)	\$920.00	\$616.40	\$300.00

# Overhauled CMI/Bendix Magnetos (cont'd)

Prices effective January 2017

Part Number	Description	List Price	Direct Price	Core Charge
10-163050-1R	Magneto (CMI/Bendix 200 Series)	\$920.00	\$616.40	\$300.00
10-163050-2R	Magneto (CMI/Bendix 200 Series)	\$920.00	\$616.40	\$300.00
10-163050-6R	Magneto (CMI/Bendix 200 Series)	\$920.00	\$616.40	\$300.00
10-163050-7R	Magneto (CMI/Bendix 200 Series)	\$920.00	\$616.40	\$300.00
10-163050-8R	Magneto (CMI/Bendix 200 Series)	\$920.00	\$616.40	\$300.00
10-163050-9R	Magneto (CMI/Bendix 200 Series)	\$920.00	\$616.40	\$300.00
10-163055-1R	Magneto (CMI/Bendix 200 Series)	\$920.00	\$616.40	\$300.00
10-163060-1R	Magneto (CMI/Bendix 200 Series)	\$920.00	\$616.40	\$300.00
10-163060-2R	Magneto (CMI/Bendix 200 Series)	\$920.00	\$616.40	\$300.00
10-349220-4R	Magneto (CMI/Bendix 1200 Series)	\$957.00	\$641.19	\$500.00
10-349220-5R	Magneto (CMI/Bendix 1200 Series)	\$957.00	\$641.19	\$500.00
10-349235-3R	Magneto (CMI/Bendix 1200 Series)	\$910.00	\$609.70	\$500.00
10-349260-3R	Magneto (CMI/Bendix 1200 Series)	\$1,190.00	\$797.30	\$500.00
10-349260-4R	Magneto (CMI/Bendix 1200 Series)	\$910.00	\$609.70	\$500.00
10-349260-6R	Magneto (CMI/Bendix 1200 Series)	\$957.00	\$641.19	\$500.00
10-349260-7R	Magneto (CMI/Bendix 1200 Series)	\$957.00	\$641.19	\$500.00
10-349270-7R	Magneto (CMI/Bendix 1200 Series)	\$910.00	\$609.70	\$500.00
10-349285-1R	Magneto (CMI/Bendix 1200 Series)	\$1,190.00	\$797.30	\$500.00
10-349285-5R	Magneto (CMI/Bendix 1200 Series)	\$910.00	\$609.70	\$500.00
10-349285-7R	Magneto (CMI/Bendix 1200 Series)	\$1,190.00	\$797.30	\$500.00
10-349290-1R	Magneto (CMI/Bendix 1200 Series)	\$957.00	\$641.19	\$500.00
10-349290-2R	Magneto (CMI/Bendix 1200 Series)	\$1,190.00	\$797.30	\$500.00
10-349290-3R	Magneto (CMI/Bendix 1200 Series)	\$910.00	\$609.70	\$500.00
10-349290-4R	Magneto (CMI/Bendix 1200 Series)	\$1,190.00	\$797.30	\$500.00
10-349290-9R	Magneto (CMI/Bendix 1200 Series)	\$1,240.00	\$830.80	\$500.00
10-349290-17R	Magneto (CMI/Bendix 1200 Series)	\$1,150.00	\$770.50	\$500.00
10-349300-4R	Magneto (CMI/Bendix 1200 Series)	\$2,950.00	\$1,976.50	\$500.00
10-349305-1R	Magneto (CMI/Bendix 1200 Series)	\$910.00	\$609.70	\$500.00
10-349305-2R	Magneto (CMI/Bendix 1200 Series)	\$910.00	\$609.70	\$500.00
10-349305-3R	Magneto (CMI/Bendix 1200 Series)	\$1,190.00	\$797.30	\$500.00
10-349305-4R	Magneto (CMI/Bendix 1200 Series)	\$910.00	\$609.70	\$500.00
10-349310-1R	Magneto (CMI/Bendix 1200 Series)	\$920.00	\$616.40	\$500.00
10-349310-2R	Magneto (CMI/Bendix 1200 Series)	\$910.00	\$609.70	\$500.00
10-349310-3R	Magneto (CMI/Bendix 1200 Series)	\$910.00	\$609.70	\$500.00
10-349310-4R	Magneto (CMI/Bendix 1200 Series)	\$1,150.00	\$770.50	\$500.00
10-349310-5R	Magneto (CMI/Bendix 1200 Series)	\$910.00	\$609.70	\$500.00
10-349310-8R	Magneto (CMI/Bendix 1200 Series)	\$910.00	\$609.70	\$500.00
10-349310-10R	Magneto (CMI/Bendix 1200 Series)	\$1,190.00	\$797.30	\$500.00
10-349310-11R	Magneto (CMI/Bendix 1200 Series)	\$1,190.00	\$797.30	\$500.00
10-349310-14R	Magneto (CMI/Bendix 1200 Series)	\$1,150.00	\$770.50	\$500.00

# Overhauled CMI/Bendix Magnetos (cont'd)

Prices effective January 2017

Part Number	Description	List Price	Direct Price	Core Charge
10-349320-4R	Magneto (CMI/Bendix 1200 Series)	\$2,900.00	\$1,943.00	\$500.00
10-349350-4R	Magneto (CMI/Bendix 1200 Series)	\$1,160.00	\$777.20	\$500.00
10-349350-5R	Magneto (CMI/Bendix 1200 Series)	\$1,160.00	\$777.20	\$500.00
10-349350-6R	Magneto (CMI/Bendix 1200 Series)	\$1,190.00	\$797.30	\$500.00
10-349350-7R	Magneto (CMI/Bendix 1200 Series)	\$1,190.00	\$797.30	\$500.00
10-349365-1R	Magneto (CMI/Bendix 1200 Series)	\$1,070.00	\$716.90	\$500.00
10-349365-3R	Magneto (CMI/Bendix 1200 Series)	\$1,040.00	\$696.80	\$500.00
10-349365-6R	Magneto (CMI/Bendix 1200 Series)	\$1,190.00	\$797.30	\$500.00
10-349365-9R	Magneto (CMI/Bendix 1200 Series)	\$1,060.00	\$710.20	\$500.00
10-349365-10R	Magneto (CMI/Bendix 1200 Series)	\$1,300.00	\$871.00	\$500.00
10-349370-1R	Magneto (CMI/Bendix 1200 Series)	\$1,040.00	\$696.80	\$500.00
10-349370-2R	Magneto (CMI/Bendix 1200 Series)	\$1,040.00	\$696.80	\$500.00
10-349370-4R	Magneto (CMI/Bendix 1200 Series)	\$1,160.00	\$777.20	\$500.00
10-349370-6R	Magneto (CMI/Bendix 1200 Series)	\$1,040.00	\$696.80	\$500.00
10-349420-1R	Magneto (CMI/Bendix 1200 Series)	\$1,190.00	\$797.30	\$500.00
10-349420-2R	Magneto (CMI/Bendix 1200 Series)	\$1,100.00	\$737.00	\$500.00
10-349460-1R	Magneto (CMI/Bendix 1200 Series)	\$1,300.00	\$871.00	\$500.00
10-349460-2R	Magneto (CMI/Bendix 1200 Series)	\$1,300.00	\$871.00	\$500.00
10-349490-1R	Magneto (CMI/Bendix 1200 Series)	\$1,190.00	\$797.30	\$500.00
10-349490-2R	Magneto (CMI/Bendix 1200 Series)	\$1,300.00	\$871.00	\$500.00
10-349490-3R	Magneto (CMI/Bendix 1200 Series)	\$1,190.00	\$797.30	\$500.00
10-349500-1R	Magneto (CMI/Bendix 1200 Series)	\$3,340.00	\$2,237.80	\$500.00
10-349510-2R	Magneto (CMI/Bendix 1200 Series)	\$1,220.00	\$817.40	\$500.00
10-349510-3R	Magneto (CMI/Bendix 1200 Series)	\$1,010.00	\$676.70	\$500.00
10-349520-1R	Magneto (CMI/Bendix 1200 Series)	\$3,340.00	\$2,237.80	\$500.00
10-382555-10R	Dual Magneto (CMI/Bendix D2000 Series)	\$2,250.00	\$1,507.50	\$400.00
10-382555-11R	Dual Magneto (CMI/Bendix D2000 Series)	\$2,250.00	\$1,507.50	\$400.00
10-382555-12R	Dual Magneto (CMI/Bendix D2000 Series)	\$2,250.00	\$1,507.50	\$400.00
10-382555-13R	Dual Magneto (CMI/Bendix D2000 Series)	\$2,250.00	\$1,507.50	\$400.00
10-382555-14R	Dual Magneto (CMI/Bendix D2000 Series)	\$2,250.00	\$1,507.50	\$400.00
10-382555-15R	Dual Magneto (CMI/Bendix D2000 Series)	\$2,250.00	\$1,507.50	\$400.00
10-382555-16R	Dual Magneto (CMI/Bendix D2000 Series)	\$2,250.00	\$1,507.50	\$400.00
10-382555-151R	Dual Magneto (CMI/Bendix D2000 Series)	\$2,250.00	\$1,507.50	\$400.00
10-382560-11R	Dual Magneto (CMI/Bendix D2000 Series)	\$2,250.00	\$1,507.50	\$400.00
10-382560-13R	Dual Magneto (CMI/Bendix D2000 Series)	\$2,250.00	\$1,507.50	\$400.00
10-382605-10R	Dual Magneto (CMI/Bendix D2000 Series)	\$2,250.00	\$1,507.50	\$400.00
10-382605-13R	Dual Magneto (CMI/Bendix D2000 Series)	\$2,250.00	\$1,507.50	\$400.00
10-382610-11R	Dual Magneto (CMI/Bendix D2000 Series)	\$2,250.00	\$1,507.50	\$400.00
10-382610-13R	Dual Magneto (CMI/Bendix D2000 Series)	\$2,250.00	\$1,507.50	\$400.00
10-382610-14R	Dual Magneto (CMI/Bendix D2000 Series)	\$2,250.00	\$1,507.50	\$400.00

# Overhauled CMI/Bendix Magnetos (cont'd)

Prices effective January 2017

Part Number	Description	List Price	Direct Price	Core Charge
10-382610-221R	Dual Magneto (CMI/Bendix D2000 Series)	\$2,250.00	\$1,507.50	\$400.00
10-382620-11R	Dual Magneto (CMI/Bendix D2000 Series)	\$2,250.00	\$1,507.50	\$400.00
10-382910-13R	Dual Magneto (CMI/Bendix D2000 Series)	\$2,250.00	\$1,507.50	\$400.00
10-382910-18R	Dual Magneto (CMI/Bendix D2000 Series)	\$2,250.00	\$1,507.50	\$400.00
10-382920-11R	Dual Magneto (CMI/Bendix D2000 Series)	\$2,250.00	\$1,507.50	\$400.00
10-500514-1R	Magneto (CMI/Bendix 20 Series)	\$1,040.00	\$696.80	\$300.00
10-500514-2R	Magneto (CMI/Bendix 20 Series)	\$1,300.00	\$871.00	\$300.00
10-500514-3R	Magneto (CMI/Bendix 20 Series)	\$1,300.00	\$871.00	\$300.00
10-500514-4R	Magneto (CMI/Bendix 20 Series)	\$1,190.00	\$797.30	\$300.00
10-500514-5R	Magneto (CMI/Bendix 20 Series)	\$1,190.00	\$797.30	\$300.00
10-500514-8R	Magneto (CMI/Bendix 20 Series)	\$1,040.00	\$696.80	\$300.00
10-500514-201R	Magneto (CMI/Bendix 20 Series)	\$1,040.00	\$696.80	\$300.00
10-500516-2R	Magneto (CMI/Bendix 20 Series)	\$1,080.00	\$723.60	\$300.00
10-500516-3R	Magneto (CMI/Bendix 20 Series)	\$1,200.00	\$804.00	\$300.00
10-500516-4R	Magneto (CMI/Bendix 20 Series)	\$1,080.00	\$723.60	\$300.00
10-500516-5R	Magneto (CMI/Bendix 20 Series)	\$1,190.00	\$797.30	\$300.00
10-500516-6R	Magneto (CMI/Bendix 20 Series)	\$1,300.00	\$871.00	\$300.00
10-500516-7R	Magneto (CMI/Bendix 20 Series)	\$1,300.00	\$871.00	\$300.00
10-500516-9R	Magneto (CMI/Bendix 20 Series)	\$1,190.00	\$797.30	\$300.00
10-500516-10R	Magneto (CMI/Bendix 20 Series)	\$1,190.00	\$797.30	\$300.00
10-500556-1R	Magneto (CMI/Bendix 20 Series)	\$1,040.00	\$696.80	\$300.00
10-500556-3R	Magneto (CMI/Bendix 20 Series)	\$1,080.00	\$723.60	\$300.00
10-500556-101R	Magneto (CMI/Bendix 20 Series)	\$1,080.00	\$723.60	\$300.00
10-500556-103R	Magneto (CMI/Bendix 20 Series)	\$1,080.00	\$723.60	\$300.00
10-500556-203R	Magneto (CMI/Bendix 20 Series)	\$1,300.00	\$871.00	\$300.00
10-500556-901R	Magneto (CMI/Bendix 20 Series)	\$1,016.00	\$680.72	\$300.00
10-51360-26R	Magneto (CMI/Bendix 20 Series)	\$1,016.00	\$680.72	\$300.00
10-51360-27R	Magneto (CMI/Bendix 20 Series)	\$1,016.00	\$680.72	\$300.00
10-51360-28R	Magneto (CMI/Bendix 20 Series)	\$1,054.00	\$706.18	\$300.00
10-51360-29R	Magneto (CMI/Bendix 20 Series)	\$1,016.00	\$680.72	\$300.00
10-51360-37R	Magneto (CMI/Bendix 20 Series)	\$1,226.00	\$821.42	\$300.00
10-51360-41R	Magneto (CMI/Bendix 20 Series)	\$1,016.00	\$680.72	\$300.00
10-51360-45R	Magneto (CMI/Bendix 20 Series)	\$1,016.00	\$680.72	\$300.00
10-51360-46R	Magneto (CMI/Bendix 20 Series)	\$888.00	\$594.96	\$300.00
10-51360-47R	Magneto (CMI/Bendix 20 Series)	\$1,016.00	\$680.72	\$300.00
10-51360-48R	Magneto (CMI/Bendix 20 Series)	\$1,016.00	\$680.72	\$300.00
10-51360-54R	Magneto (CMI/Bendix 20 Series)	\$1,016.00	\$680.72	\$300.00
10-51360-55R	Magneto (CMI/Bendix 20 Series)	\$1,016.00	\$680.72	\$300.00
10-51360-58R	Magneto (CMI/Bendix 20 Series)	\$1,016.00	\$680.72	\$300.00
10-51365-9R	Magneto (CMI/Bendix 20 Series)	\$1,016.00	\$680.72	\$300.00

# Overhauled CMI/Bendix Magnetos (cont'd)

Prices effective January 2017

Part Number	Description	List Price	Direct Price	Core Charge
10-51365-32R	Magneto (CMI/Bendix 20 Series)	\$1,016.00	\$680.72	\$300.00
10-51365-33R	Magneto (CMI/Bendix 20 Series)	\$1,016.00	\$680.72	\$300.00
10-51365-34R	Magneto (CMI/Bendix 20 Series)	\$1,168.00	\$782.56	\$300.00
10-51365-35R	Magneto (CMI/Bendix 20 Series)	\$1,016.00	\$680.72	\$300.00
10-51365-39R	Magneto (CMI/Bendix 20 Series)	\$1,168.00	\$782.56	\$300.00
10-51365-40R	Magneto (CMI/Bendix 20 Series)	\$1,054.00	\$706.18	\$300.00
10-51365-43R	Magneto (CMI/Bendix 20 Series)	\$1,170.00	\$783.90	\$300.00
10-51365-44R	Magneto (CMI/Bendix 20 Series)	\$1,016.00	\$680.72	\$300.00
10-51365-45R	Magneto (CMI/Bendix 20 Series)	\$1,016.00	\$680.72	\$300.00
10-51365-46R	Magneto (CMI/Bendix 20 Series)	\$1,016.00	\$680.72	\$300.00
10-51365-47R	Magneto (CMI/Bendix 20 Series)	\$1,170.00	\$783.90	\$300.00
10-51365-48R	Magneto (CMI/Bendix 20 Series)	\$1,170.00	\$783.90	\$300.00
10-51365-57R	Magneto (CMI/Bendix 20 Series)	\$1,054.00	\$706.18	\$300.00
10-52350-19R	Magneto (CMI/Bendix 20 Series)	\$1,170.00	\$783.90	\$300.00
10-52350-20R	Magneto (CMI/Bendix 20 Series)	\$1,016.00	\$680.72	\$300.00
10-52350-22R	Magneto (CMI/Bendix 20 Series)	\$1,016.00	\$680.72	\$300.00
10-52350-23R	Magneto (CMI/Bendix 20 Series)	\$1,168.52	\$782.91	\$300.00
10-600604-1R	Magneto (CMI/Bendix 200 Series)	\$1,190.00	\$797.30	\$300.00
10-600606-1R	Magneto (CMI/Bendix 200 Series)	\$1,040.00	\$696.80	\$300.00
10-600606-3R	Magneto (CMI/Bendix 200 Series)	\$1,300.00	\$871.00	\$300.00
10-600614-1R	Magneto (CMI/Bendix 200 Series)	\$1,000.00	\$670.00	\$300.00
10-600614-2R	Magneto (CMI/Bendix 200 Series)	\$1,300.00	\$871.00	\$300.00
10-600614-3R	Magneto (CMI/Bendix 200 Series)	\$1,190.00	\$797.30	\$300.00
10-600616-3R	Magneto (CMI/Bendix 200 Series)	\$1,000.00	\$670.00	\$300.00
10-600616-4R	Magneto (CMI/Bendix 200 Series)	\$1,190.00	\$797.30	\$300.00
10-600616-5R	Magneto (CMI/Bendix 200 Series)	\$1,190.00	\$797.30	\$300.00
10-600616-6R	Magneto (CMI/Bendix 200 Series)	\$1,190.00	\$797.30	\$300.00
10-600616-7R	Magneto (CMI/Bendix 200 Series)	\$1,300.00	\$871.00	\$300.00
10-600616-9R	Magneto (CMI/Bendix 200 Series)	\$1,000.00	\$670.00	\$300.00
10-600616-101R	Magneto (CMI/Bendix 200 Series)	\$1,300.00	\$871.00	\$300.00
10-600644-1R	Magneto (CMI/Bendix 200 Series)	\$1,000.00	\$670.00	\$300.00
10-600644-3R	Magneto (CMI/Bendix 200 Series)	\$1,190.00	\$797.30	\$300.00
10-600644-4R	Magneto (CMI/Bendix 200 Series)	\$1,190.00	\$797.30	\$300.00
10-600644-5R	Magneto (CMI/Bendix 200 Series)	\$1,040.00	\$696.80	\$300.00
10-600644-201R	Magneto (CMI/Bendix 200 Series)	\$1,040.00	\$696.80	\$300.00
10-600644-202R	Magneto (CMI/Bendix 200 Series)	\$1,040.00	\$696.80	\$300.00
10-600646-1R	Magneto (CMI/Bendix 200 Series)	\$1,000.00	\$670.00	\$300.00
10-600646-2R	Magneto (CMI/Bendix 200 Series)	\$1,100.00	\$737.00	\$300.00
10-600646-3R	Magneto (CMI/Bendix 200 Series)	\$1,190.00	\$797.30	\$300.00
10-600646-4R	Magneto (CMI/Bendix 200 Series)	\$1,190.00	\$797.30	\$300.00

# Overhauled CMI/Bendix Magnetos (cont'd)

Prices effective January 2017

Part Number	Description	List Price	Direct Price	Core Charge
10-600646-101R	Magneto (CMI/Bendix 200 Series)	\$1,300.00	\$871.00	\$300.00
10-600646-201R	Magneto (CMI/Bendix 200 Series)	\$1,000.00	\$670.00	\$300.00
10-600654-1R	Magneto (CMI/Bendix 200 Series)	\$1,190.00	\$797.30	\$300.00
10-600656-1R	Magneto (CMI/Bendix 200 Series)	\$1,040.00	\$696.80	\$300.00
10-600656-3R	Magneto (CMI/Bendix 200 Series)	\$1,190.00	\$797.30	\$300.00
10-682555-11R	Dual Magneto (CMI/Bendix D3000 Series)	\$2,666.00	\$1,786.22	\$1,000.00
10-682555-13R	Dual Magneto (CMI/Bendix D3000 Series)	\$2,666.00	\$1,786.22	\$1,000.00
10-682555-14R	Dual Magneto (CMI/Bendix D3000 Series)	\$2,666.00	\$1,786.22	\$1,000.00
10-682555-15R	Dual Magneto (CMI/Bendix D3000 Series)	\$2,666.00	\$1,786.22	\$1,000.00
10-682555-16R	Dual Magneto (CMI/Bendix D3000 Series)	\$2,666.00	\$1,786.22	\$1,000.00
10-682555-141R	Dual Magneto (CMI/Bendix D3000 Series)	\$2,666.00	\$1,786.22	\$1,000.00
10-682555-151R	Dual Magneto (CMI/Bendix D3000 Series)	\$2,666.00	\$1,786.22	\$1,000.00
10-682560-11R	Dual Magneto (CMI/Bendix D3000 Series)	\$2,680.00	\$1,795.60	\$1,000.00
10-682560-13R	Dual Magneto (CMI/Bendix D3000 Series)	\$2,680.00	\$1,795.60	\$1,000.00
10-682605-13R	Dual Magneto (CMI/Bendix D3000 Series)	\$2,680.00	\$1,795.60	\$1,000.00
10-682610-13R	Dual Magneto (CMI/Bendix D3000 Series)	\$2,732.00	\$1,830.44	\$1,000.00
10-682620-11R	Dual Magneto (CMI/Bendix D3000 Series)	\$3,204.00	\$2,146.68	\$1,000.00
10-682910-13R	Dual Magneto (CMI/Bendix D3000 Series)	\$2,808.00	\$1,881.36	\$1,000.00
10-682910-18R	Dual Magneto (CMI/Bendix D3000 Series)	\$2,808.00	\$1,881.36	\$1,000.00
10-79020-10R	Magneto (CMI/Bendix 20 Series)	\$1,016.00	\$680.72	\$300.00
10-79020-16R	Magneto (CMI/Bendix 20 Series)	\$1,016.00	\$680.72	\$300.00
10-79020-17R	Magneto (CMI/Bendix 20 Series)	\$1,016.00	\$680.72	\$300.00
10-79020-18R	Magneto (CMI/Bendix 20 Series)	\$1,016.00	\$680.72	\$300.00
10-79020-19R	Magneto (CMI/Bendix 20 Series)	\$1,016.00	\$680.72	\$300.00
10-79020-118R	Magneto (CMI/Bendix 20 Series)	\$1,388.00	\$929.96	\$300.00
10-79020-119R	Magneto (CMI/Bendix 20 Series)	\$1,202.00	\$805.34	\$300.00

# Overhauled Slick Magnetos

Part Number	Description	List Price	Direct Price	Core Charge
4301R	Magneto: 25D, LH OVH	\$985.50	\$660.29	\$300.00
4302R	Magneto: 0D, RH OVH	\$952.66	\$638.28	\$300.00
4309R	Magneto: 0D, LH OVH	\$952.66	\$638.28	\$300.00
4310R	Magneto: 30D, LH OVH	\$1,149.76	\$770.34	\$300.00
4316R	Magneto: 25D, RH OVH	\$1,204.50	\$807.02	\$150.00
4330R	Magneto: 30D, RH OVH	\$1,149.76	\$770.34	\$300.00
4333R	Magneto: 25D, LH OVH	\$1,204.50	\$807.02	\$300.00
4342R	Magneto: 0D, LH OVH	\$1,029.30	\$689.63	\$150.00
4344R	Magneto: 0D, RH OVH	\$1,029.30	\$689.63	\$150.00
4345R	Magneto: 15D, LH OVH	\$1,149.76	\$770.34	\$150.00
4347R	Magneto: 25D, LH OVH	\$985.50	\$660.29	\$150.00

# Overhauled Slick Magnets (cont'd)

Prices effective January 2017

Part Number	Description	List Price	Direct Price	Core Charge
4348R	Magneto: 25D, RH OVH	\$1,204.50	\$807.02	\$150.00
4353R	Magneto: 0D, LH OVH	\$985.50	\$660.29	\$150.00
4354R	Magneto: 25D, LH OVH	\$1,204.50	\$807.02	\$150.00
4370R	Magneto: 0D, LH OVH	\$930.76	\$623.61	\$150.00
4371R	Magneto: 25D, LH OVH	\$985.50	\$660.29	\$150.00
4372R	Magneto: 15D, LH OVH	\$985.50	\$660.29	\$150.00
4373R	Magneto: 25D, LH OVH	\$985.50	\$660.29	\$150.00
4374R	Magneto: 15D, RH OVH	\$1,029.30	\$689.63	\$150.00
4381R	Magneto: 5D, LH OVH	\$985.50	\$660.29	\$300.00
4392R	Magneto: 30D, OVH	\$1,204.50	\$807.02	\$150.00
6309R	Magneto: 35D, RH OVH	\$1,204.50	\$807.02	\$150.00
6310R	Magneto: 30D, RH OVH	\$985.50	\$660.29	\$150.00
6313R	Magneto: 0D, RH OVH	\$1,204.50	\$807.02	\$150.00
6314R	Magneto: 30D, LH OVH	\$1,149.76	\$770.34	\$150.00
6320R	Magneto: 30D, RH OVH	\$985.50	\$660.29	\$150.00
6324R	Magneto: 30D, LH OVH	\$1,149.76	\$770.34	\$150.00
6331R	Magneto: 30D, LH OVH	\$1,204.50	\$807.02	\$150.00
6340R	Magneto: 0D, RH OVH	\$1,029.30	\$689.63	\$150.00
6350R	Magneto: 0D, LH OVH	\$930.76	\$623.61	\$150.00
6351R	Magneto: 35D, LH OVH	\$985.50	\$660.29	\$150.00
6355R	Magneto: 45D, LH OVH	\$1,204.50	\$807.02	\$300.00
6360R	Magneto: 0D, LH OVH	\$952.66	\$638.28	\$150.00
6361R	Magneto: 35D, LH OVH	\$1,029.30	\$689.63	\$150.00
6362R	Magneto: 30D, RH OVH	\$1,204.50	\$807.02	\$150.00
6363R	Magneto: 30D, LH OVH	\$1,149.76	\$770.34	\$150.00
6364R	Magneto: 35D, LH OVH	\$1,149.76	\$770.34	\$150.00
6365R	Magneto: 25D, LH OVH	\$1,204.50	\$807.02	\$150.00
6367R	Magneto: 35D, RH OVH	\$1,204.50	\$807.02	\$150.00
6371R	Magneto: 0D, LH OVH	\$1,029.30	\$689.63	\$150.00
6377R	Magneto: 30D, RH OVH	\$1,204.50	\$807.02	\$150.00
6379R	Magneto: 45D, LH OVH	\$1,204.50	\$807.02	\$150.00
6380R	Magneto: 30D, RH OVH	\$1,204.50	\$807.02	\$150.00
6382R	Magneto: 30D, RH OVH	\$1,204.50	\$807.02	\$150.00
6390R	Magneto: 0D, LH OVH	\$1,029.30	\$689.63	\$150.00
6391R	Magneto: 25D, RH OVH	\$1,204.50	\$807.02	\$150.00
6393R	Magneto: 37D, LH OVH	\$985.50	\$660.29	\$150.00
6394R	Magneto: 30D, RH OVH	\$1,029.30	\$689.63	\$150.00
6399R	Magneto: 35D, RH OVH	\$1,204.50	\$807.02	\$150.00

# CMI/Bendix Magneto PMA Replacement Parts

Prices effective January 2017

Part Number	Description	List Price	Direct Price
AB-102083	Screw	\$3.60	\$2.41
AB-14268	Washer	\$2.20	\$1.47
AB-157158	Screw	\$3.30	\$2.21
AB-157160	Screw	\$2.10	\$1.41
AB-160844	Carbon Brush	\$7.90	\$5.29
AB-163374	Felt Strip	\$1.20	\$0.80
AB-2-202	Ball Bearing	\$72.00	\$48.24
AB-349263	Packing	\$1.40	\$0.94
AB-349326	Fish Paper	\$3.80	\$2.55
AB-349511	Washer	\$7.10	\$4.76
AB-349652	Screw	\$8.50	\$5.70
AB-357173	Breaker Points	\$63.50	\$42.55
AB-357174	Breaker Points	\$61.30	\$41.07
AB-357281	Capacitor	\$132.20	\$88.57
AB-357424	Distributor Block	\$132.80	\$88.98
AB-357426	Distributor Block	\$195.10	\$130.72
AB-357584	Gear Kit	\$129.00	\$86.43
AB-357586	Gear Kit	\$197.80	\$132.53
AB-382568	Fish Paper	\$3.00	\$2.01
AB-382584	Contact Assembly Kit	\$67.90	\$45.49
AB-382585	Contact Assembly Kit	\$59.10	\$39.60
AB-382622	Contact Assembly Kit	\$114.10	\$76.45
AB-382681	Capacitor	\$147.50	\$98.83
AB-382681-1	Capacitor	\$171.90	\$115.17
AB-382788	Washer	\$5.80	\$3.89
AB-382789	Screw	\$6.98	\$4.68
AB-382807	Capacitor	\$166.50	\$111.56
AB-382881	Screw	\$8.40	\$5.63
AB-382936	Nut	\$2.30	\$1.54
AB-382959	Screw	\$32.40	\$21.71
AB-382971	Bearing	\$62.00	\$41.54
AB-391200	Lube Block	\$86.00	\$57.62
AB-391213	Screw	\$2.80	\$1.88
AB-391309	Washer	\$4.60	\$3.08
AB-400550-1	Grease, 16 oz.	\$86.00	\$57.62
AB-400550-2	Grease, 2 oz.	\$31.00	\$20.77
AB-400623	Ball Bearing	\$34.50	\$23.12
AB-50752	Felt Washer	\$1.30	\$0.87
AB-50765	Clamp Coil	\$8.80	\$5.90
AB-51678	Oil Slinger	\$11.10	\$7.44
AB-53397	Washer	\$0.80	\$0.54



# CMI/Bendix Magneto PMA Replacement Parts (cont'd)

Prices effective January 2017

Part Number	Description	List Price	Direct Price
AB-55501	Washer	\$2.40	\$1.61
AB-606505	Washer	\$0.56	\$0.38
AB-682014	Gear Kit	\$260.60	\$174.60
AB-682016	Gear Kit	\$260.60	\$174.60
AB-86527	Lubricant, Felt 8 oz.	\$55.00	\$36.85
AB-90751-18	Cotter Pin	\$1.90	\$1.27
AB-90751-19	Cotter Pin	\$1.90	\$1.27
AB-90788-5	Woodruff Key	\$1.90	\$1.27
AB-92815-37	Snap Ring	\$1.30	\$0.87
AB-92815-62	Snap Ring	\$1.90	\$1.27
ES10-125996	Bushing	\$7.10	\$4.76
ES10-163048	Bushing	\$117.10	\$78.46
ES10-163049	Bushing	\$117.70	\$78.86
ES10-17050	Washer	\$23.00	\$15.41
ES10-349219	Wedge	\$16.90	\$11.32
ES10-349248	Slinger, Oil	\$42.20	\$28.27
ES10-349326	Strip	\$3.80	\$2.55
ES10-349392-1	Flange	\$189.70	\$127.10
ES10-349392-2	Flange	\$271.40	\$181.84
ES10-349392-3	Flange	\$243.50	\$163.15
ES10-349392-4	Flange	\$262.30	\$175.74
ES10-349392-5	Flange	\$296.70	\$198.79
ES10-349392-6	Flange	\$263.90	\$176.81
ES10-349970	Breaker Points	\$84.80	\$56.82
ES10-349971	Breaker Points	\$82.50	\$55.28
ES10-353056	Bearing	\$32.60	\$21.84
ES10-353060	Bearing	\$25.50	\$17.09
ES10-357078	Bushing	\$33.70	\$22.58
ES10-357164-1	Coil	\$292.40	\$195.91
ES10-357165-1	Coil	\$292.40	\$195.91
ES10-357173	Breaker Points	\$63.50	\$42.55
ES10-357174	Breaker Points	\$61.30	\$41.07
ES10-357193	Bushing	\$216.70	\$145.19
ES10-357584	Gear Kit	\$129.00	\$86.43
ES10-357586	Gear Kit	\$197.80	\$132.53
ES10-35935-5	Screw	\$4.00	\$2.68
ES10-35935-6	Screw	\$2.00	\$1.34
ES10-35936-7	Screw	\$2.80	\$1.88
ES10-35937-8	Screw	\$3.30	\$2.21
ES10-35937-20	Screw	\$3.90	\$2.61

# CMI/Bendix Magneto PMA Replacement Parts (cont'd)

Prices effective January 2017

Part Number	Description	List Price	Direct Price
ES10-361631	Breaker Points	\$152.10	\$101.91
ES10-3793	Washer	\$6.10	\$4.09
ES10-382584	Breaker Points	\$67.90	\$45.49
ES10-382585	Breaker Points	\$59.10	\$39.60
ES10-382588-1	Coil	\$332.20	\$222.57
ES10-382618	Hex Nut	\$20.80	\$13.94
ES10-382622	Breaker Points	\$114.10	\$76.45
ES10-382642	Breaker Points	\$127.20	\$85.22
ES10-382681-1	Capacitor	\$171.90	\$115.17
ES10-382747	Impulse Coupling Body	\$263.30	\$176.41
ES10-382748	Impulse Coupling Body	\$458.40	\$307.13
ES10-382767	Impulse Coupling Body	\$473.00	\$316.91
ES10-382768	Impulse Coupling Body	\$339.20	\$227.26
ES10-382785	Connector Strip	\$36.60	\$24.52
ES10-382787	Bearing Retainer Plate	\$158.90	\$106.46
ES10-382790-1	Coil	\$413.10	\$276.78
ES10-382811	Gasket	\$83.70	\$56.08
ES10-382815	Bushing	\$51.60	\$34.57
ES10-382931	Coil Retention Spring	\$34.60	\$23.18
ES10-382952	Impulse Coupling Body	\$336.00	\$225.12
ES10-382961	Impulse Coupling Body	\$336.00	\$225.12
ES10-391088-1	Coil	\$377.30	\$252.79
ES10-391389	Gasket	\$52.70	\$35.31
ES10-391401	Gasket	\$33.30	\$22.31
ES10-391584	Distributor Block	\$147.30	\$98.69
ES10-391586	Distributor Block	\$134.90	\$90.38
ES10-400042	Spring	\$144.90	\$97.08
ES10-400166-1	Impulse Cam Assembly	\$354.80	\$237.72
ES10-400166-2	Impulse Cam Assembly	\$354.80	\$237.72
ES10-400166-4	Impulse Cam Assembly	\$354.80	\$237.72
ES10-400166-5	Impulse Cam Assembly	\$354.80	\$237.72
ES10-400166-6	Impulse Cam Assembly	\$354.80	\$237.72
ES10-400166-7	Impulse Cam Assembly	\$354.80	\$237.72
ES10-400166-9	Impulse Cam Assembly	\$354.80	\$237.72
ES10-400167-1	Impulse Cam Assembly	\$354.80	\$237.72
ES10-400167-2	Impulse Cam Assembly	\$354.80	\$237.72
ES10-400167-4	Impulse Cam Assembly	\$354.80	\$237.72
ES10-400167-5	Impulse Cam Assembly	\$354.80	\$237.72
ES10-400167-6	Impulse Cam Assembly	\$354.80	\$237.72
ES10-400167-7	Impulse Cam Assembly	\$354.80	\$237.72
ES10-400167-8	Impulse Cam Assembly	\$354.80	\$237.72
ES10-400167-9	Impulse Cam Assembly	\$354.80	\$237.72

# CMI/Bendix Magneto PMA Replacement Parts (cont'd)

Prices effective January 2017

Part Number	Description	List Price	Direct Price
ES10-400167-10	Impulse Cam Assembly	\$354.80	\$237.72
ES10-400167-12	Impulse Cam Assembly	\$354.80	\$237.72
ES10-400167-13	Impulse Cam Assembly	\$354.80	\$237.72
ES10-400302	Impulse Coupling Assembly	\$537.50	\$360.13
ES10-400303	Impulse Coupling Assembly	\$537.50	\$360.13
ES10-400305	Impulse Coupling Assembly	\$537.50	\$360.13
ES10-400306	Impulse Coupling Assembly	\$537.50	\$360.13
ES10-400307	Impulse Coupling Assembly	\$537.50	\$360.13
ES10-400308	Impulse Coupling Assembly	\$537.50	\$360.13
ES10-400309	Impulse Coupling Assembly	\$537.50	\$360.13
ES10-400311	Impulse Coupling Assembly	\$494.50	\$331.32
ES10-400312	Impulse Coupling Assembly	\$537.50	\$360.13
ES10-400313	Impulse Coupling Assembly	\$537.50	\$360.13
ES10-400314	Impulse Coupling Assembly	\$537.50	\$360.13
ES10-400315	Impulse Coupling Assembly	\$537.50	\$360.13
ES10-400316	Impulse Coupling Assembly	\$537.50	\$360.13
ES10-400317	Impulse Coupling Assembly	\$537.50	\$360.13
ES10-400318	Impulse Coupling Assembly	\$537.50	\$360.13
ES10-400319	Impulse Coupling Assembly	\$537.50	\$360.13
ES10-400320	Impulse Coupling Assembly	\$537.50	\$360.13
ES10-400321	Impulse Coupling Assembly	\$537.50	\$360.13
ES10-400322	Impulse Coupling Assembly	\$494.50	\$331.32
ES10-400323	Impulse Coupling Assembly	\$494.50	\$331.32
ES10-400324	Impulse Coupling Assembly	\$494.50	\$331.32
ES10-400325	Impulse Coupling Assembly	\$494.50	\$331.32
ES10-400326	Impulse Coupling Assembly	\$494.50	\$331.32
ES10-400327	Impulse Coupling Assembly	\$537.50	\$360.13
ES10-4093	Washer	\$1.10	\$0.74
ES10-50732	Vent	\$32.80	\$21.98
ES10-50737	Spring	\$1.50	\$1.01
ES10-51324	Spring	\$43.50	\$29.15
ES10-51333	Impulse Coupling Body	\$264.10	\$176.95
ES10-51391	Plug	\$12.00	\$8.04
ES10-51676	Capacitor	\$41.30	\$27.67
ES10-52903	Impulse Coupling Body	\$259.20	\$173.66
ES10-53397	Washer	\$0.80	\$0.54
ES10-682014	Gear Assembly	\$260.60	\$174.60
ES10-682016	Gear Assembly	\$260.60	\$174.60
ES10-682054	Distributor Block	\$411.60	\$275.77
ES10-682056	Distributor Block	\$462.90	\$310.14
ES10-685548	Washer	\$0.80	\$0.54
ES10-70371	Impulse Coupling Body	\$245.10	\$164.22

# CMI/Bendix Magneto PMA Replacement Parts (cont'd)

Prices effective January 2017

Part Number	Description	List Price	Direct Price
ES10-76232	Impulse Coupling Body	\$257.50	\$172.53
ES10-81806	Ball Bearing	\$48.30	\$32.36
ES2-202	Bearing	\$72.00	\$48.24
KA10-16092	Washer	\$2.20	\$1.47
KA10-35937-12	Screw	\$7.80	\$5.23
KA10-361639	Bushing	\$53.10	\$35.58
KA10-382568	Strip	\$3.00	\$2.01
KA10-400554	Oil Seal	\$22.00	\$14.74
KA10-400572	Capacitor	\$132.20	\$88.57
KA10-400574	Capacitor	\$166.50	\$111.56
KA10-400576	Capacitor	\$147.50	\$98.83
KA10-400615	Capacitor	\$117.70	\$78.86
KA10-682024	Screw	\$7.80	\$5.23
MF3A	Ign/Filter Capacitor	\$114.60	\$76.78

# Slick Magneto PMA Replacement Parts

Prices effective January 2017

Part Number	Description	List Price	Direct Price
A-13009	Coil	\$432.00	\$289.44
A-13081	Contact Assembly	\$70.50	\$47.24
A-13081-8	Contact Lube	\$1.78	\$1.19
AM-2536	Woodruff Key	\$1.20	\$0.80
AM-2540	Cotter Pin	\$0.78	\$0.52
AM-3006	Ball Bearing	\$51.00	\$34.17
AM-3015	Screw	\$1.60	\$1.07
AM-3020	Screw	\$1.10	\$0.74
AM-3021	Screw	\$0.98	\$0.66
AM-3062	Oil Seal	\$13.30	\$8.91
AM-3183	Capacitor	\$165.00	\$110.55
AM-3183-1	Nut	\$0.62	\$0.42
AM-3183-2	Washer	\$0.62	\$0.42
AM-3215	Brush & Spring	\$11.90	\$7.97
AM-3485	Bearing & Cap Assembly	\$108.00	\$72.36
ES1077	Air Vent	\$6.20	\$4.16
ES3018	Bearing Cap Clamp	\$1.76	\$1.18
ES3019	Nut	\$7.50	\$5.03
ES3040	Coil Wedge	\$12.80	\$8.58
ES3084	Air Vent w/ Hood	\$25.50	\$17.09
ES3172	Washer	\$5.42	\$3.64
ES3179	Vent Plug	\$7.00	\$4.69
ES3180	Tube Fitting	\$12.20	\$8.18
ES3307	Pressure Gasket Kit	\$95.50	\$63.99
ES3331	Oil Seal	\$14.50	\$9.72
ES3637	Contact Point	\$101.50	\$68.01
ES3740	Contact Point	\$195.00	\$130.66
ES3826	Spacer	\$3.16	\$2.12
ES917	Impulse Spring	\$29.70	\$19.90

# CMI/Bendix Magneto Repair Kits

Prices effective January 2017

Deluxe kits contain: All repair kit contents plus coil, block, gear

Repair kits contain: Contacts, capacitor, bearings, oil seal, oil slinger, woodruff key, cotter pin, cam screw, felt washer, felt strip, snap ring and carbon brush

Part Number	Description	List Price	Direct Price
AB-200445-D	Magneto Repair Kit – Deluxe	\$928.92	\$622.38
AB-200445-R	Magneto Repair Kit - Repair	\$413.54	\$277.07
AB-200445SC-D	Magneto Repair Kit – Deluxe	\$914.56	\$612.76
AB-200445SC-R	Magneto Repair Kit - Repair	\$399.20	\$267.46
AB-200484-D	Magneto Repair Kit – Deluxe	\$872.76	\$584.75
AB-200484-R	Magneto Repair Kit - Repair	\$357.40	\$239.46
AB-200485-D	Magneto Repair Kit – Deluxe	\$864.40	\$579.15
AB-200485-R	Magneto Repair Kit - Repair	\$349.04	\$233.86
AB-200645-D	Magneto Repair Kit – Deluxe	\$1,053.46	\$705.82
AB-200645-R	Magneto Repair Kit - Repair	\$413.54	\$277.07
AB-200645SC-D	Magneto Repair Kit – Deluxe	\$1,039.12	\$696.21
AB-200645SC-R	Magneto Repair Kit - Repair	\$399.20	\$267.46
AB-200684-D	Magneto Repair Kit – Deluxe	\$997.32	\$668.20
AB-200684-R	Magneto Repair Kit - Repair	\$357.40	\$239.46
AB-200685-D	Magneto Repair Kit – Deluxe	\$1,053.46	\$705.82
AB-200685-R	Magneto Repair Kit - Repair	\$349.04	\$233.86
AB-473-D	Magneto Repair Kit – Deluxe	\$781.66	\$523.71
AB-473-R	Magneto Repair Kit - Repair	\$266.28	\$178.41
AB-474-D	Magneto Repair Kit – Deluxe	\$779.58	\$522.32
AB-474-R	Magneto Repair Kit - Repair	\$264.20	\$177.01
AB-484-D	Magneto Repair Kit – Deluxe	\$872.76	\$584.75
AB-484-R	Magneto Repair Kit - Repair	\$357.40	\$239.46
AB-484SC-D	Magneto Repair Kit – Deluxe	\$858.42	\$575.14
AB-484SC-R	Magneto Repair Kit - Repair	\$343.04	\$229.84
AB-485-D	Magneto Repair Kit – Deluxe	\$864.40	\$579.15
AB-485-R	Magneto Repair Kit - Repair	\$334.68	\$224.24
AB-485SC-D	Magneto Repair Kit – Deluxe	\$906.20	\$607.15
AB-485SC-R	Magneto Repair Kit - Repair	\$334.68	\$224.24
AB-673-D	Magneto Repair Kit – Deluxe	\$906.20	\$607.15
AB-674-D	Magneto Repair Kit - Deluxe	\$904.12	\$605.76
AB-674-R	Magneto Repair Kit - Minor	\$264.20	\$177.01
AB-684-D	Magneto Repair Kit - Deluxe	\$997.32	\$668.20
AB-684-R	Magneto Repair Kit - Minor	\$357.40	\$239.46
AB-684SC-D	Magneto Repair Kit - Deluxe	\$982.96	\$658.58
AB-684SC-R	Magneto Repair Kit - Minor	\$343.04	\$229.84
AB-685-D	Magneto Repair Kit - Deluxe	\$988.96	\$662.60
AB-685-R	Magneto Repair Kit - Minor	\$349.04	\$233.86
AB-685SC-D	Magneto Repair Kit - Deluxe	\$974.60	\$652.98
AB-685SC-R	Magneto Repair Kit - Minor	\$334.68	\$224.24
AB-673-R	Magneto Repair Kit - Repair	\$266.28	\$178.41

# Harness Replacement Parts

Prices effective January 2017

See page 22 for parts drawing

Part Number	Description	List Price	Direct Price
109-2	3/4 Nut	\$24.20	\$16.21
113-2	5/8 Nut	\$22.60	\$15.14
121	Spring Assembly	\$5.90	\$3.95
147	Terminal	\$11.00	\$7.37
148A	Insulator	\$10.30	\$6.90
148B	Brass Retainer	\$6.80	\$4.56
2391	Insulator & Retainer Assembly	\$10.10	\$6.77
2392	Insulator	\$9.30	\$6.23
2446-2	3/4 Elbow Assembly	\$38.70	\$25.93
2463-2	5/8 Elbow Assembly	\$38.70	\$25.93
70043	Ferrule	\$20.40	\$13.67
70044	Ferrule	\$21.00	\$14.07
70046	Ferrule	\$14.00	\$9.38
E100-72	72in 3/4 Nut Lead Assy w/Elbow	\$150.50	\$100.84
E200-72	72 in 5/8 Nut Lead Assy w/Elbow	\$150.50	\$100.84
S100-72	72in 3/4 Nut Lead Assy	\$139.80	\$93.67
S200-72	72in 5/8 Nut Lead Assy	\$139.80	\$93.67

## Parts Breakdown for 5/8 Nut

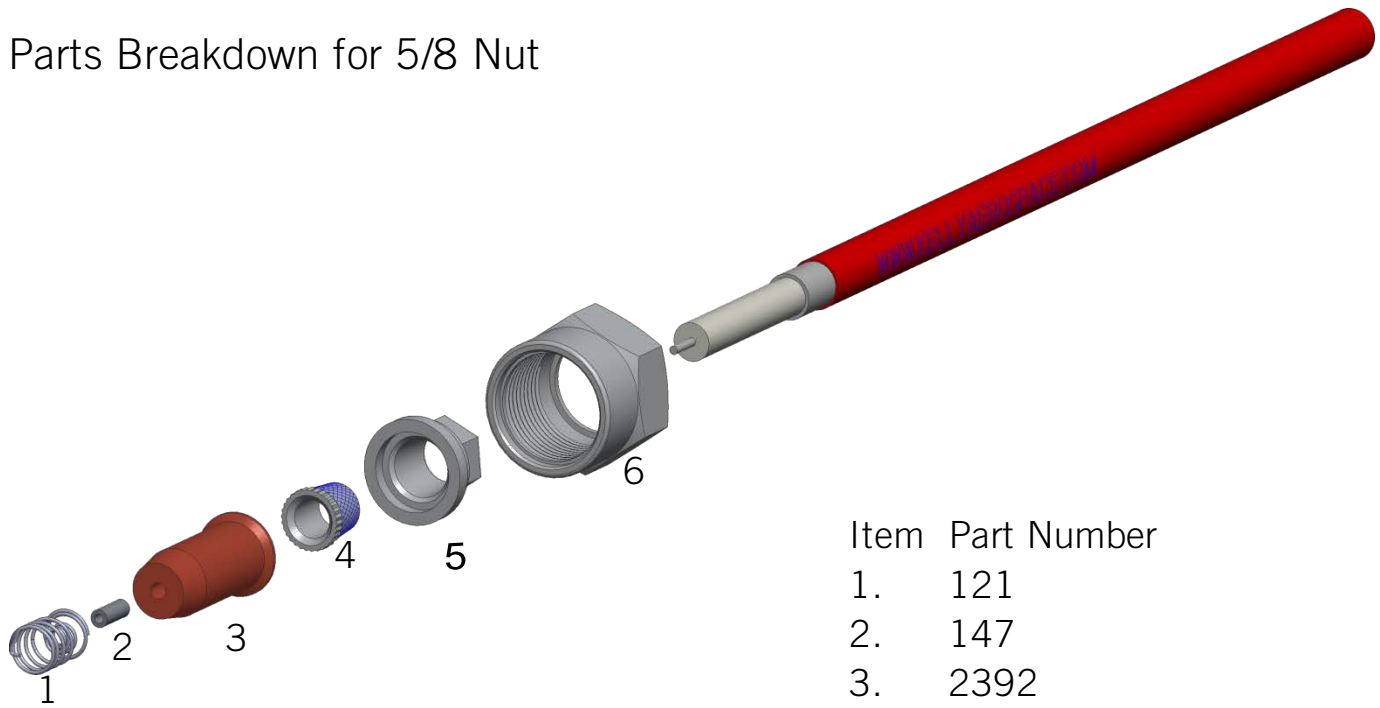

Item	Part Number
1.	121
2.	147
3.	2392
4.	70046
5.	70043
6.	113-2

## Parts Breakdown for 3/4 Nut

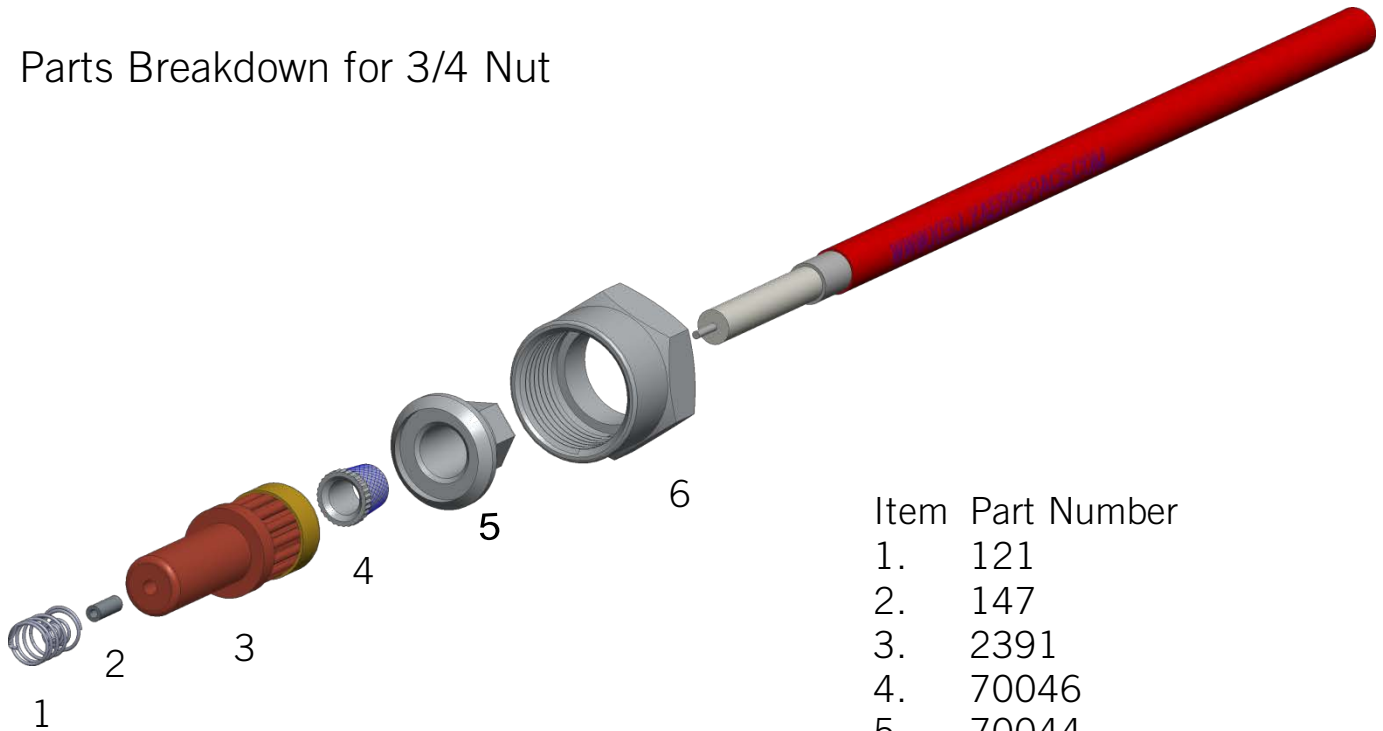

Item	Part Number
1.	121
2.	147
3.	2391
4.	70046
5.	70044
6.	109-2



## Limited Warranty Policy

Kelly Aerospace Energy Systems (KAES) warrants that all new, rebuilt or overhauled products (or minor revision derivatives thereof), sold by Kelly Aerospace Energy Systems, Montgomery Alabama, shall be free from defects in material and workmanship under normal use and service for a period of ONE YEAR ON ALL NEW COMPONENTS and SIX MONTHS ON ALL OVERHAULED COMPONENTS.

The warranty period begins (unless otherwise noted) from the date of installation into the aircraft if, and only if, the following conditions are met:

1. The unit and warranty claim, with all requested information properly supplied has been returned to any authorized KAES distributor. International Customers may utilize a KAES Authorized Service Center or a KAES Distributor. Units must be returned within 30 days of the product failure date. Units must not be disassembled and in their "as removed" condition.
2. No substitute parts shall have been installed in the product without prior authorization of KAES, Montgomery, Alabama.
3. The product shall not have been disassembled, repaired, or altered outside of KAES approved facilities unless express prior authorization was granted in writing.
4. The product shall not have been subject to misuse, accident, or improper installation unless proof is submitted to the satisfaction of KAES that such abuse was not a cause for the claimed defect.
5. The duration of this Limited Warranty shall be for the unused portion of the original warranty period. Any replacement unit or repair shall not establish a new warranty period.

\* Units will be activated automatically for a shelf stock warranty period and in all cases shall expire thirty-six (36) months from date of manufacture (see I.D. plate). Units held in distribution stock over thirty-six (36) months can be returned to the factory for complete testing, recertification, new warranty, and new packaging for a nominal charge.

## Limitations & Exclusions:

1. The sole responsibility and liability of KAES and your exclusive remedy under this claim arising out of, connected with, or resulting from, this sale or the performance or breach of any condition or warranty there under, or from the manufacture, delivery, or use of the product shall be the repair of, or replacement, or credit for this defective product at KAES's option.
2. IN NO EVENT, WHETHER AS A RESULT OF A BREACH OF CONTRACT, WARRANTY, TORT (INCLUDING NEGLIGENCE), OR OTHERWISE, SHALL KAES BE LIABLE FOR ANY SPECIAL, CONSEQUENTIAL, INCIDENTAL, OR PENAL DAMAGES OR EXPENSES, INCLUDING BUT NOT LIMITED TO, COSTS OF REMOVAL AND REPLACEMENT OF THE PRODUCT(S), LOSS OF PROFIT, GOODWILL, OR REVENUES, LOSS OF USE OF THE PRODUCT OR ANY ASSOCIATED EQUIPMENT, DAMAGE TO ASSOCIATED EQUIPMENT, COST OF CAPITAL, COST OF SUBSTITUTE PRODUCTS, FACILITIES, OR SERVICES, DOWN TIME, OR COSTS OR CLAIMS OF THIRD PARTIES FOR SUCH DAMAGES OR EXPENSES.

## Specific Terms:

1. The foregoing warranty is exclusive and in lieu of all other warranties or remedies whether written, oral, implied, or statutory. Any and all implied warranties of merchantability, fitness for a particular purpose, course of dealing or usage of trade are hereby expressly disclaimed and excluded.
2. Acceptance of the product by you shall constitute your acknowledgment and acceptance of the terms, provisions, limitations, and exclusions set forth herein. Such terms, provisions, limitations, and exclusions shall not be modified, deleted, or supplemented except by an express written acknowledgment of KAES.

## General:

1. Any claims under this warranty should be made through a KAES authorized distributor or service center. Any claim made, which cannot be reasonably duplicated, will not be considered applicable to warranty and shall be returned "as is". All claims shall be handled according to standard warranty procedures; see your authorized distributor for details. A list of KAES distributors may be obtained from [www.KellyAerospace.com](http://www.KellyAerospace.com) or by Tel: (334) 286-8551.
2. All products returned by a distributor for warranty consideration are to be shipped to Kelly Aerospace Energy Systems, 1400 E. South Blvd., Montgomery, Alabama 36116 (USA) freight prepaid. If the warranty claim is accepted, the replacement parts, if shipped individually, will be shipped surface freight, prepaid.

## Core Chargeback Policy:

Any unit being returned for core or warranty core credit shall be 'as-removed' from the engine, complete and not disassembled. Units that are rusty, corroded, or cannot be overhauled for any reason will be classified as scrap, having no value. Units which have been weld repaired, as well as units which have been disassembled and then reassembled with old parts will also be classified as scrap, having no value. A percentage of the core charge or a flat dollar value will be charged for missing or damaged parts. (See listing) At no time will the damaged or missing parts charge on any unit exceed the core value of that unit.

1. Core charges are due in full within terms. Core credits will only be issued within 12 months from the date of invoice.
2. Cores returned in excess of cores invoiced will become the property of KAES and will only be credited for up to 10% of the unit core charge.
3. Cores must be of like purchase or a direct superseded unit.

CMI/Bendix/Slick Magneto Core Chargebacks	20/200/1200 D2000 Series	D3000 Series	Slick 4300/6300
Drive Plates or Impulse Bushing Missing	10%	5%	10%
Capacitors Missing (Each)	15%	5%	15%
Breaker Cover Missing/Damaged	20%	5%	N/A
Distributor/Rotor Gear Missing/Damaged Each	15%	5%	25%
Mounting Flange Missing/Damaged	25%	N/A	N/A
Distributor Block Missing/Damaged	35%	15%	35%
Coil Missing/Inop	50%	15%	50%
Impulse Coupling Missing/Damaged	50%	15%	75%
Distributor Housing Missing/Damaged (20/200)	65%	N/A	65%
Magneto Housing Missing/Damaged (Non D3000)	70%	N/A	80%
Magneto Housing Missing/Damaged (D3000)	N/A	60%	N/A
Rotating Magnet Bent/Old style flat sided/Inop	75%	25%	80%

## **Returned Goods Policy:**

Kelly Aerospace Energy Systems will accept returned goods with the following conditions:

1. The part must have been originally purchased from KAES and must be a current production part in its original packaging.
2. Parts may be returned within 60 days after the original invoice without restocking charges so long as the product is in its original form and packaging.
3. Parts returned after 60 days from original invoice are subject to a minimum of 20% restocking charge.
4. No merchandise returns will be accepted after one year from original date of shipment.
5. All returns must include: Date of purchase; KAES Invoice number; and the reason for the return.

A part return request form can be obtained from KAES customer service and may be reached at 334-286-8551 or email at [sales@kellyaerospace.com](mailto:sales@kellyaerospace.com).